



## Mark details

<b>Nine figure</b>	348901160	<b>Mark name</b>	SKIPTON PM 116
<b>Status</b>	OK	<b>Alternate names</b>	GBM 86
<b>Last used by</b>	GEOD	<b>Stamped ID</b>	
<b>Date last used</b>	09/12/2009	<b>Map</b>	752213
<b>Beacon</b>			
<b>Type</b>	SCN (GDA), SCN (AHD)Permanent Mark		
<b>Plan numbers</b>	PS 619349F		

**Marker Post Exists****Cover Exists****Mark Type****GNSS Suitability****Ground to Mark****Offset****Comments**

## Coordinates

<b>Projection (MGA94)</b>		<b>Datum (GDA94)</b>	
<b>Easting</b>	708745.706	<b>Latitude</b>	-37° 41' 11.2763"
<b>Northing</b>	5826334.072	<b>Longitude</b>	143° 22' 02.5322"
<b>Zone</b>	54	<b>Ellipsoid height</b>	290.821
<b>Uncertainty</b>	0.006	<b>Order</b>	3
<b>Published date</b>	26/09/2016	<b>Technique</b>	ADJUSTMENT
<b>Source</b>	OSGV	<b>Measurements</b>	DGHLM

## AHD

<b>Height</b>	287.555	<b>Technique</b>	SPIRIT LEVELLING
<b>Uncertainty</b>	0.009	<b>Order</b>	3
<b>Published date</b>	14/07/2014	<b>Level section</b>	524
<b>Source</b>	OSGV		

## Point scale factor

<b>PSF</b>	1.0001367	<b>Height</b>	0.9999549	<b>Combined</b>	1.0000916
------------	-----------	---------------	-----------	-----------------	-----------

Nine figure	348901160	Status	OK	Type	SCN (GDA), SCN (AHD)
Easting	708745.706	Northing	5826334.072	AHD height	287.555
Latitude	-37° 41' 11.2763"	Longitude	143° 22' 02.5322"	Ellipsoid height	290.821
Hz uncertainty	0.006	Hz order	3	Vt uncertainty	0.009
Datum	GDA94	Plan ref	PS 619349F	Vt order	3

Shire of Hampden

3 Geo. Sec.

C.R.B.

7

SEC. 6 (1) (c) SURVEY CO-ORDINATION ACT 1940

## PERMANENT MARK SKETCH PLAN

Township SKIPTON Parish SKIPTON

NOTE:—

Not necessarily to Scale

(1) Measurements to be shown from the Permanent Mark to as many near-by survey marks, buildings, fence posts, hydrants, trees, &c., as practicable. Up to six such measurements are desirable.

(2) Except where verified by a Licensed Surveyor in this survey, all boundaries in this sketch plan are to be shown by broken lines. The symbols for fences, buildings, &c., to be shown on the broken lines.

(3) Description of Permanent Mark and, where possible, Crown Abutments are to be shown.

MEASUREMENTS ARE IN LINKS.

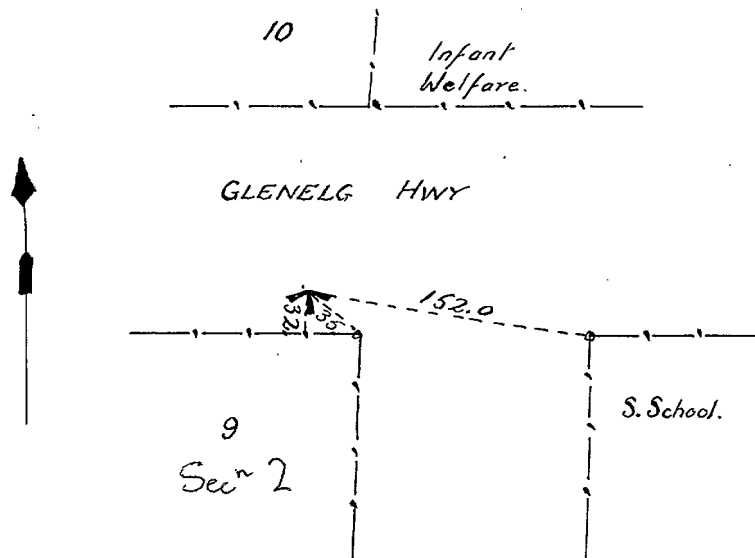

Established in connection with\* PRECISION LEVEL Ref. No. GBM 86  
\*Type of Survey or Works.

IF LEVELLED:—

Reduced level of Mark \_\_\_\_\_ to Datum  $\uparrow$  \_\_\_\_\_  
 $\uparrow$ e.g., Railways, Board of Works, Sewerage Authority, &c., or Arbitrary.

I certify that the Permanent Marks shown in this sketch have been established on the ground by me in accordance with the Regulations under the Survey Co-ordination Act 1940 and that the information shown hereon is correct.

Department or Authority LANDS & SURVEY Signature [Signature]

Date 24-9-61

$\uparrow$  If a Licensed Surveyor the letters L.S. to be added.

TO BE FILLED IN BY THE CENTRAL PLAN OFFICE

Zone	Square	Subdivision	State Datum R.L.	Number
			R.L.	
			Copied from	116 ✓

Noted on Record Plan 5289(1) 28.11.61 SEE ALSO SUPPLEMENTARY SKETCH

8 NOV 1961

Nine figure	348901160	Status	OK	Type	SCN (GDA), SCN (AHD)	
Easting	708745.706	Northing	5826334.072	AHD height	287.555	Zone 54
Latitude	-37° 41' 11.2763"	Longitude	143° 22' 02.5322"	Ellipsoid height	290.821	CSF 1.0000916
Hx uncertainty	0.006	Hx order	3	Vt uncertainty	0.009	Vt order 3
Datum	GDA94	Plan ref	PS 619349F			

SEC. 6 (1) (c) SURVEY CO-ORDINATION ACT 1958

# PERMANENT MARK SKETCH PLAN

Township SKIPTON Parish SKIPTON

Not necessarily to Scale

## NOTE

- (1) Connections to be shown to buildings, fences, poles, survey marks or monuments nearby.  
 (2) Unless verified by a licensed surveyor, all boundaries are to be shown by broken lines.  
 (3) Connection should be shown to nearest Crown allotment boundary or named street or road.
- Description of Permanent Mark Conc. Block — B.M. type plaque  
 Existence of box-cover marker post

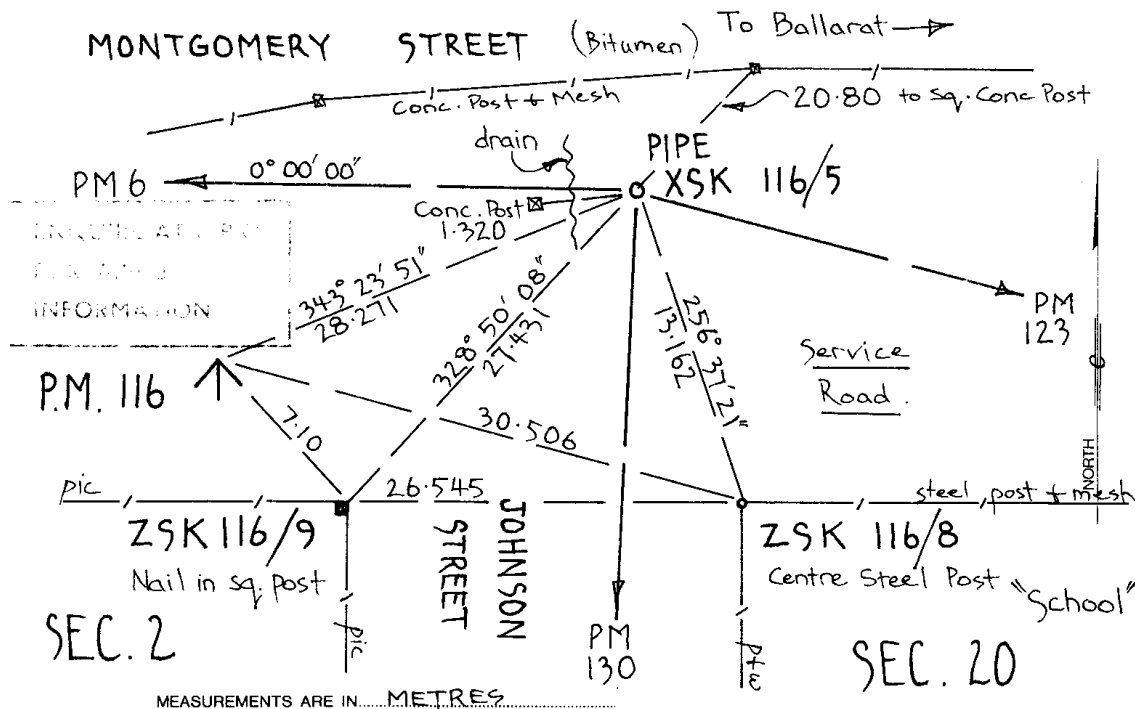

I certify that the Permanent Mark shown in this sketch has been established on the ground by me in accordance with the Regulations under the Survey Co-ordination Act 1958 and that the information shown hereon is correct.

Department ~~Authority~~ CONS. FORESTS + LANDS Signature [Signature] \* LS

Authority's Reference or Designated No.                      Date 24/5/84

Municipality                      \* If a Licensed Surveyor the Letters L.S. to be added  
 \* If a Registered Surveyor the Letters R.S. to be added.

A.M.G. REFERENCE CO-ORDINATES. (Nearest 100 metre) (May be scaled from 1:100,000 map)	TO BE FILLED IN BY C.P.O.	
	REGISTERED SURVEYS.	REGISTERED NUMBER
	CONNECTED	PARISH
	116	
ZONE		
E..... 00 .....		
N..... 00 .....		

11 APR 1985